

*****UPDATE ON ROAD CLOSURES- 160th Avenue*****

The Baseline Metropolitan District project team has confirmed the schedule for a brief closure of the east-west alignment of 160th Avenue. All lanes in the vicinity of the Sheridan Intersection with 160th Avenue will be closed to traffic during this period, but Sheridan Parkway (northbound/southbound) will remain open with restricted lanes.

Projected Dates of Closure: June 9–June 18, 2025

Detour/Closure Map below:

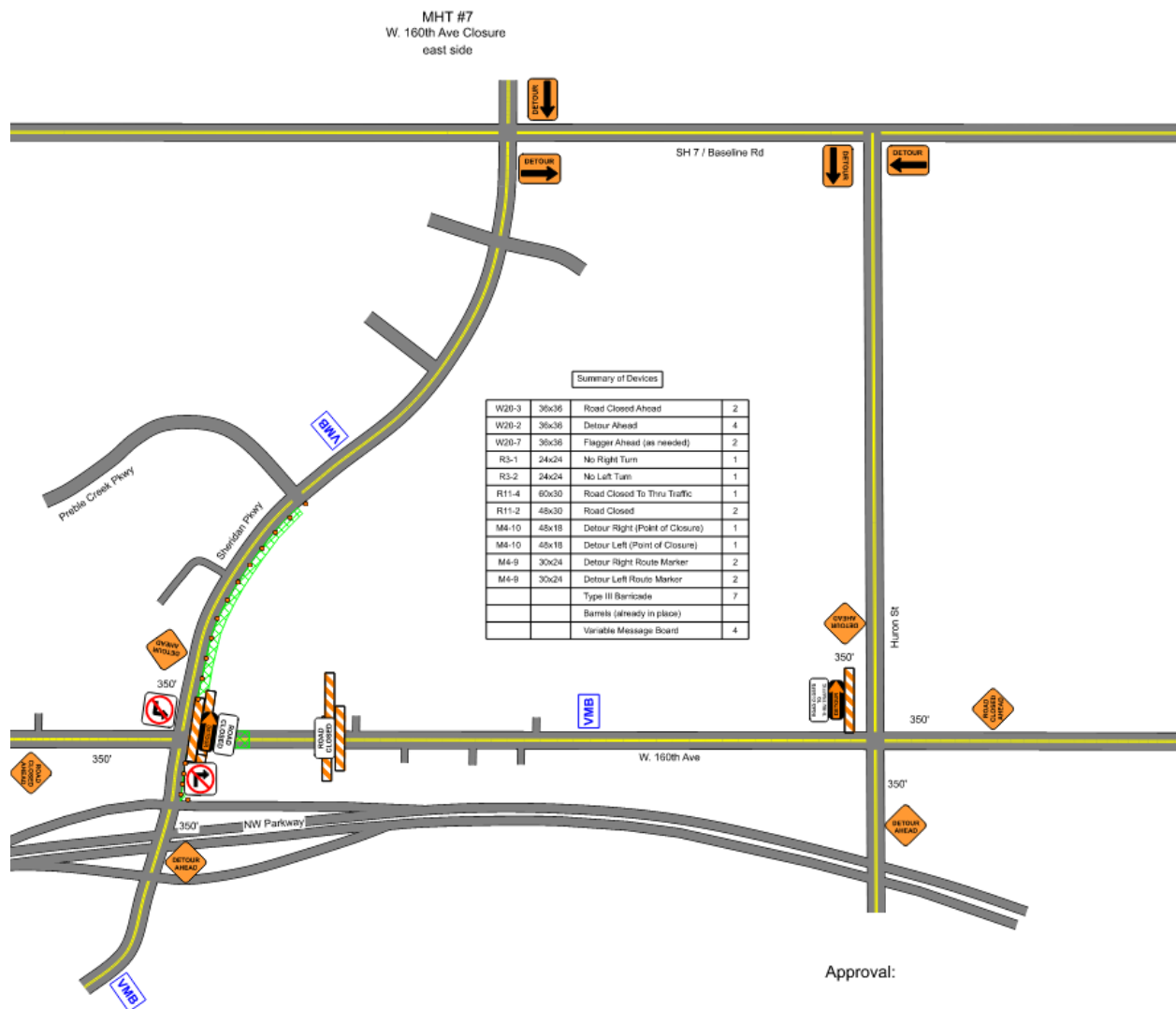

What work is happening with this closure? Final pavement completion within the intersection, with extensive grade adjustments to existing paving

within the intersection. This work will facilitate the activation of the new signals placed for all lanes and the redirection of traffic to all newly constructed lanes.